

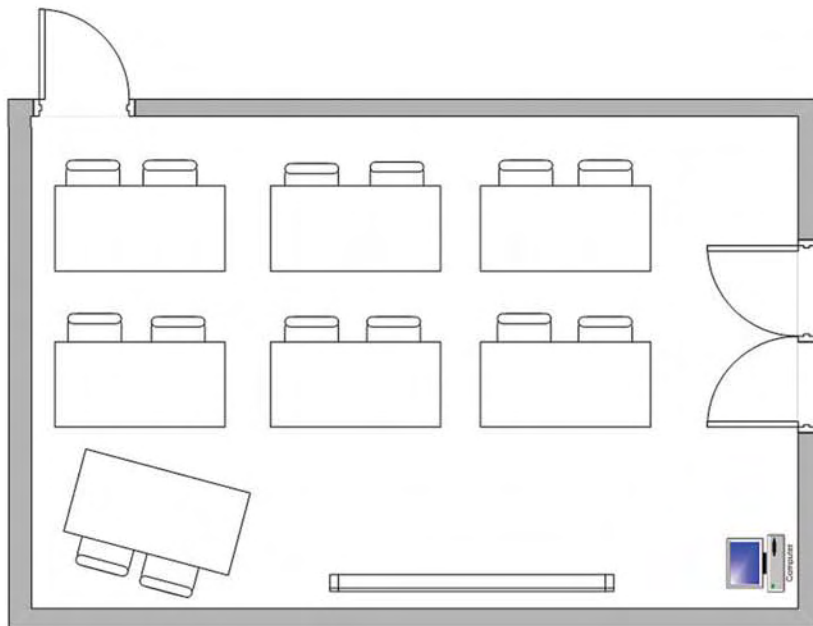

CONFERENCE  
CENTRE  
OXFORD

## MEETING ROOM WORDSWORTH *Classroom*



### CLASSROOM CAPACITY

12 persons

### ADDITIONAL FORMATS

Horseshoe 12 persons

Boardroom 16 persons

Workstation 20 persons

Boardroom (large table) 20 persons

Theatre 33 persons

### TECHNICAL SPECS

- Sony VPLCX100 LCD Projector , 2700 ANSI Lumens, 1366x800 resolution
- Marantz PMD560 audio hard disk recorder
- Sure SLX4 receiver and Microflex wireless boundary mic
- Hitachi T17XL 17" interactive LCD display panel with Starboard software
- Panasonic DMREZ48 DVD and VCR player
- Crestron TPS6X wireless touchpanel and Crestron media system
- Sony XG80, high definition multipoint videoconferencing solution
- HP Compaq CPU