

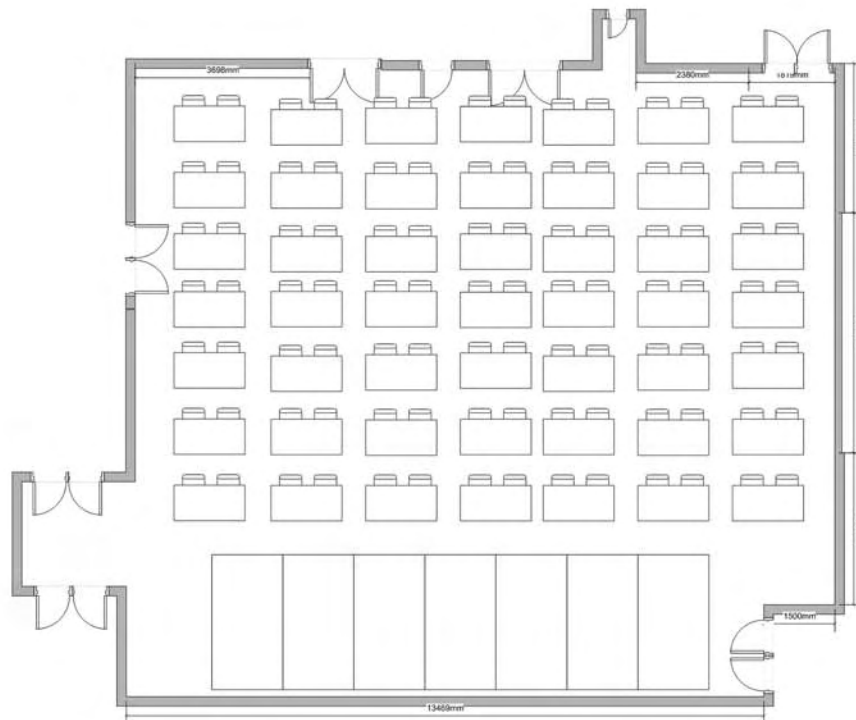

CONFERENCE
CENTRE
OXFORD

FUNCTION ROOM SHAKESPEARE *Classroom*



CLASSROOM CAPACITY

98 (7 rows of 7 tables)

ADDITIONAL FORMATS

Cabaret with stage 190 / without 220
Workstation with stage 192 / without 232
Theatre with stage 230 / without 243

TECHNICAL SPECS

Sound

- Yamaha MG24/14FX sound desk
- 6 x EV ZX5 Speakers
- 3 x P2500S Power Amps
- Alesis DEQ230 Digital EQ
- 3 x Sennheiser Hand Held Radio Mic
- 3 x Sennheiser Lapel Radio Mic
- 2 x AKG 747C Microphones
- 4 x AKG Perception 170 Microphones
- CD Player

Lighting

- 4 Source Four Jr zoom 25-50
- 2 Source Four 26 deg
- 2 x Mac 250 Moving Heads
- Vista MI Lighting Desk and PC
- Zero 88 Betapack Dimmer

Vision

- 2 x Octofade Fx Switchers
- 2 x Optoma EP783 5000L Projector
- 2 x 10'x7' Screens
- 3 x Show Computers
- 42" Comfort Monitor
- Cue System
- DVD Player

Other Facilities

- Road Ready Intellistage 6mx3m x 400m with steps and skirt
- Full Stage Black Drape Kit
- Single and Double Trilite Lecterns
- Acrylic Lectern
- Tech pro talkback system